

Calculating Area

Yeny received these plans of a property she has just bought. Help her answer some questions. Each square is 1 square metre.

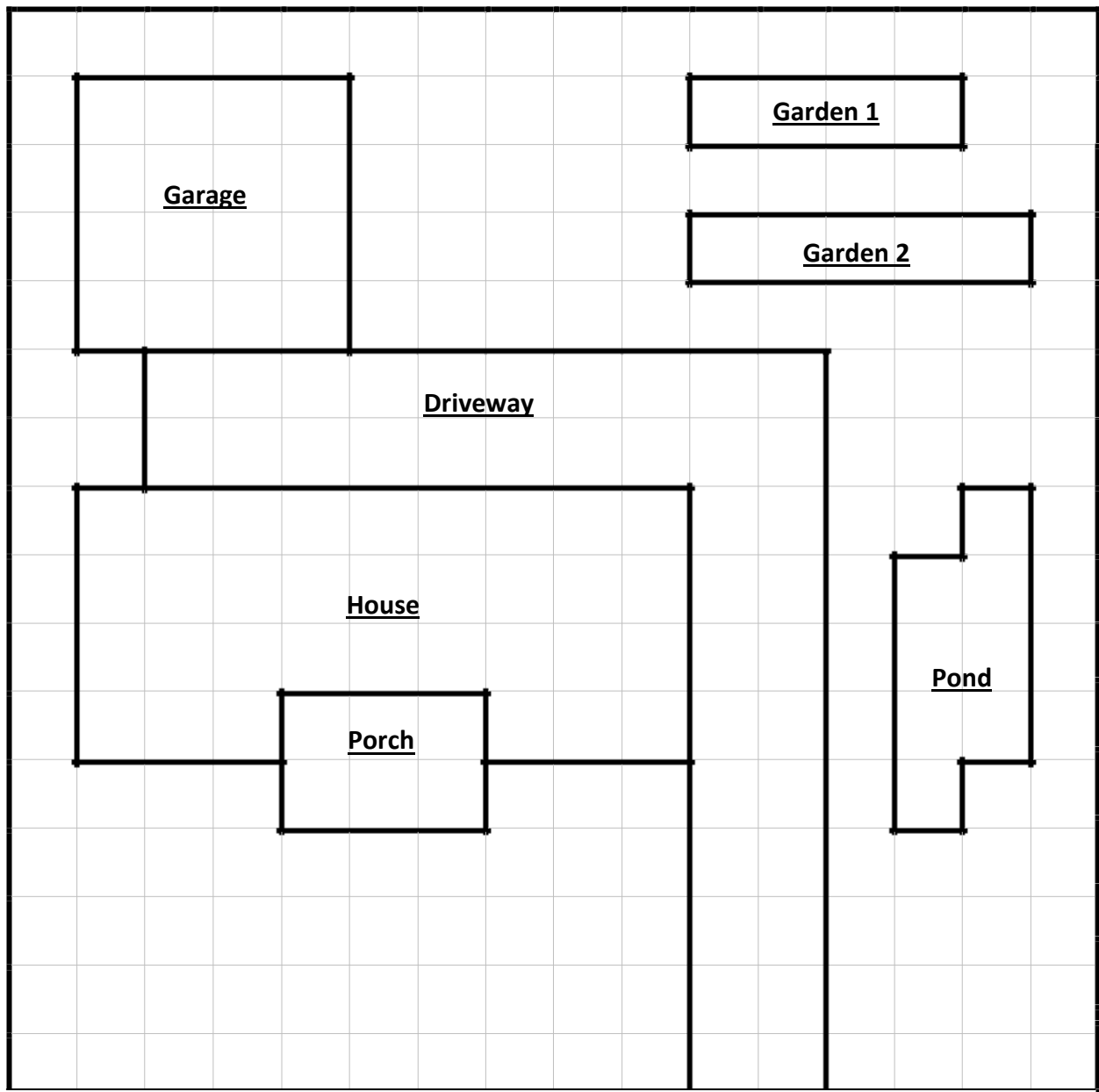

**** Remember: to find the area, you need to work out the number of squares within the shape.****

1. What is the area of the house? (Take care – the house includes the porch!)
2. What is the area of the pond?
3. What is the total area of the gardens?
4. What is the area of the driveway?
5. Yeny wants to make her garage larger. She needs one that is 22m^2 . How much larger does she need to make the new garage?
6. Draw on the plans to show where her new garage might best fit.
7. Yeny wants room to plant vegetables. Design a garden space for the front of Yeny's house. It must have a total area of 11m^2 . Yeny is not sure if she would like one large garden, or a couple of smaller ones.

Calculating Area **Answers**

Yeny received these plans of a property she has just bought. Help her answer some questions. Each square is 1 square metre.

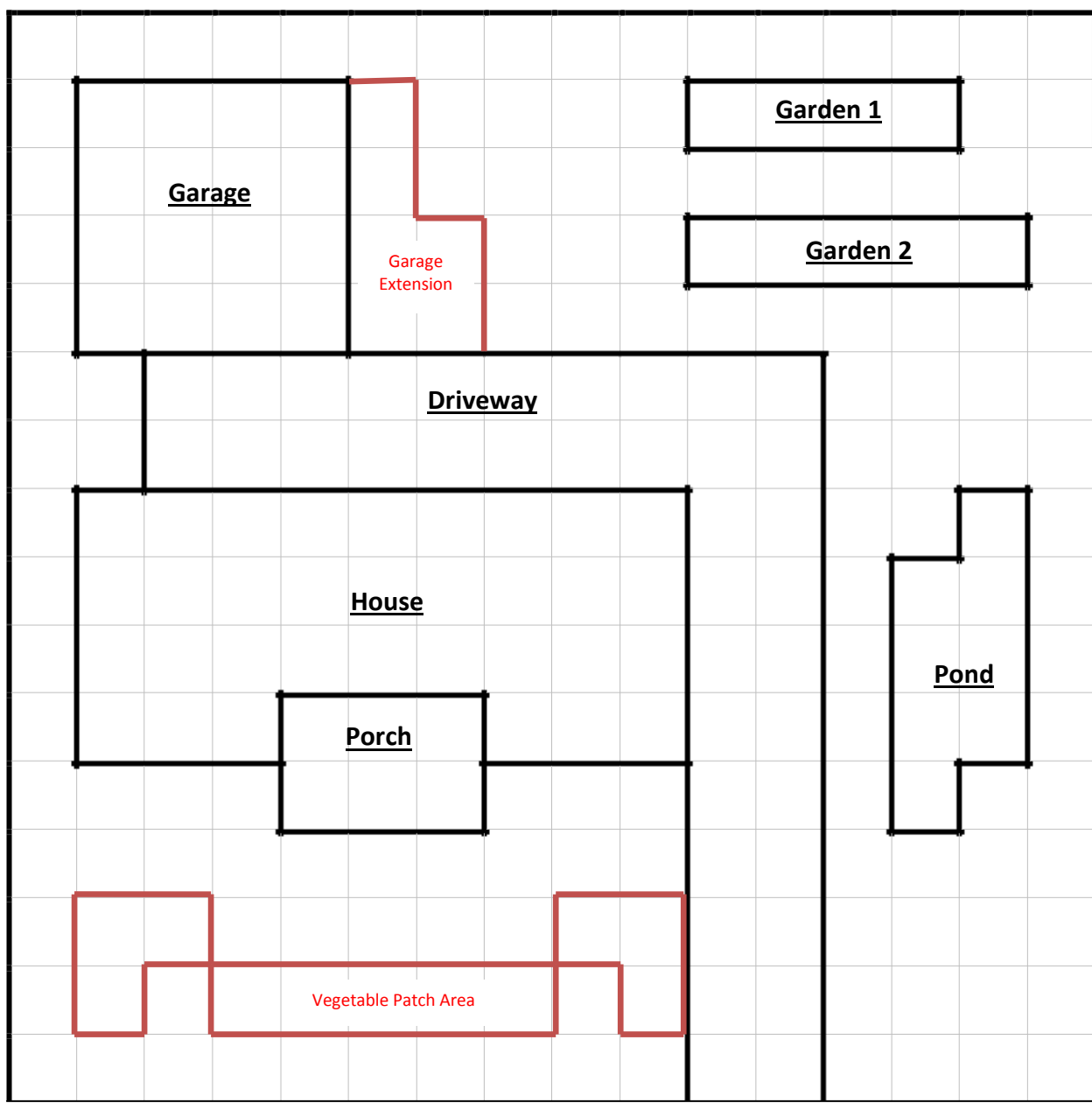

1. What is the area of the house? 39m^2
2. What is the area of the pond? 8m^2
3. What is the total area of the gardens? 9m^2
4. What is the area of the driveway? 38m^2
5. Yeny wants to make her garage larger. She needs one that is 22m^2 . How much larger does she need to make the new garage? 6m^2 larger
6. Draw on the plans to show where her new garage might best fit. *Answers will vary – only one example shown.*
7. Yeny wants room to plant vegetables. Design a garden space for the front of Yeny's house. It must have a total area of 11m^2 . Yeny is not sure if she would like one large garden, or a couple of smaller ones. *Answers will vary – only one example shown.*